

3/8" Square Drive Sockets

6 Point and Double Hex, Short & Standard Length

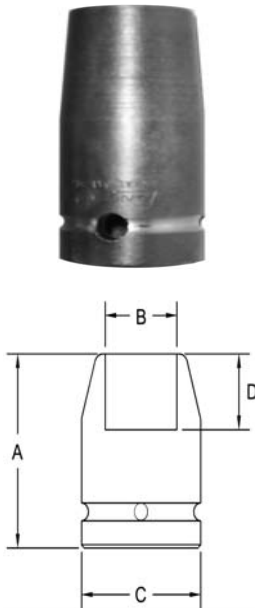

Part # 6 Point	Part # Double Hex	Hex Opening	Overall Length (A)	Diameter Nose (B)	Diameter Drive End (C)	Opening Depth (D)
2000	2000-D	1/4	1.25	.437	.750	.156
2001	2001-D	9/32	1.25	.437	.750	.187
2002	2002-D	5/16	.875	.500	.750	.187
2003	2003-D	5/16	1.25	.500	.750	.187
2004	2004-D	11/32	1.25	.500	.750	.187
2005	2005-D	3/8	.875	.593	.750	.187
2006	2006-D	3/8	1.25	.593	.750	.250
2007	2007-D	13/32	1.50	.687	.750	.250
2008	2008-D	7/16	.875	.687	.750	.281
2009	2009-D	7/16	1.50	.687	.750	.281
2010	2010-D	15/32	1.50	.750	.750	.281
2011	2011-D	1/4	.875	.812	.812	.312
2012	2012-D	1/2	1.50	.812	.812	.343
2013	2013-D	17/32	1.50	.812	.812	.343
2014	2014-D	9/16	.875	.875	.875	.312
2015	2015-D	9/16	1.50	.875	.875	.437
2016	2016-D	19/32	1.50	.875	.875	.437
2017	2017-D	5/8	1.00	.937	.937	.437
2018	2018-D	5/8	1.50	.937	.937	.437
2019	2019-D	21/32	1.50	.937	.937	.437
2020	2020-D	11/16	1.00	1.00	1.00	.437
2021	2021-D	11/16	1.50	1.00	1.00	.437
2022	2022-D	3/4	1.00	1.06	1.06	.437
2023	2023-D	3/4	1.50	1.06	1.06	.468
2024	2024-D	13/16	1.00	1.12	1.12	.437
2025	2025-D	13/16	1.50	1.12	1.12	.437
2026	2026-D	7/8	1.00	1.25	1.25	.437

Sockets can be configured with the following options:
FM = Fixed Magnet SD = Side Magnet TM = Tubular Magnet
SM = Spring Magnet FL = Fast Lead
Fixed and rotating UHMW plastic sleeves can be special ordered